

Touchpoint for direct information sharing fi-8040 Document Scanner

Ricoh's new fi-8040 scanner simplifies workgroup scanning. The intuitive interface, advanced network capabilities, and PaperStream ClickScan ease collaboration. Scan to varied destinations and capture documents as searchable PDFs for simplified data management and retrieval. Plus, setup is a breeze and the fi-8040 offers intuitive navigation that requires minimal training and has the flexibility to integrate into existing tech stacks.



The fi-8040 offers the industry-leading reliability, paper handling, and image quality you have come to expect from Ricoh fi-Series scanners. Equip your team with the fi-8040's stand-out features, including DirectScan, on-site destination entry, and an intuitive touchscreen.

DirectScan

Share scans seamlessly. Teams can easily send and save scanned data directly to a variety of destinations, including email, over a network without the need to connect to a PC— and fi-8040 supports TWAIN/ISIS drivers.

On-site destination entry

Streamline scan configurations. Users can easily add, edit, and bookmark scan destinations directly on the touchscreen interface — no need for a PC.

Touchscreen with preview

View thumbnails on the display. Preview scans on the touchscreen display before hitting "send" — without the need for a computer— simplifying remote scanning workflows.



PaperStream IP

Compatible with all major document management software packages. PaperStream IP is a TWAIN/ISIS® compliant driver that cleans up and optimizes scanned images reducing rescans and improving downstream data accuracy.

PaperStream Clickscan

Operators can quickly scan documents without administrators needing to preset scan settings or destinations. "Push" or "pull" scans can be done with just a few steps.

PaperStream Capture

Output PDF, TIFF, JPG BMP with a single click. OCR and Machine-Readable Zone can extract data from documents, passports, ID cards, etc. Built-in profiles (color, B&W, auto color) save time.

Touchpoint for direct information sharing

fi-8040 Document Scanner

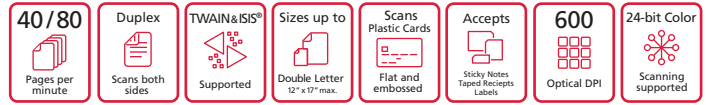

Technical Information

Scanner Type	ADF (Automatic Document Feeder)/Manual Feed, Duplex	Operating Environment	Temperature: 5 to 35 °C (41 to 95 °F) Relative Humidity: 20 to 80% (non-condensing)
Scanning Speed*1		Environmental Compliance	ENERGY STAR®, RoHS
AC Adapter		Dimensions*12	(Width x Depth x Height) 292 x 157 x 143 mm (11.5 x 6.2 x 5.6 in.)
A4 Portrait	Simplex: 40 ipm (200/300 dpi)	Weight	3.1 kg (6.8 lb)
Color*/Grayscale*/2/	Duplex : 80 ipm (200/300 dpi)	Supported Operating System	Windows® 11*13, Windows® 10*13, Windows Server® 2022, Windows Server® 2019, Windows Server® 2016, Windows Server® 2012 R2, Windows Server® 2012
Monochrome*3		Included Software / Drivers	PaperStream IP Driver (TWAIN/TWAIN x64/ISIS), WIA Driver*14, PaperStream Capture, PaperStream ClickScan*15, PaperStream NX Manager, Software Operation Panel, Error Recovery Guide, ABBYY FineReader for ScanSnap™*15, Scanner Central Admin Server, Scanner Central Admin Desktop
Image Sensor Type	CIS x 2 (front x 1, back x 1)	Image Processing Functions*16	Multi image output, Automatic color detection, Blank page detection, Dynamic threshold (iDTC), Advanced DTC, SDTC, Error diffusion, Dither, Static threshold, De-Screen, Emphasis, Dropout color (None/Red/Green/Blue/White/Saturation/Custom), sRGB output, Split image, De-Skew, Edge filler, Vertical streaks reduction, Cropping, Rotation, Barcode detection (1D&2D), Background pattern removal
Light Source	RGB LED x 2 (front x 1, back x 1)	Included Items	ADF paper chute, AC cable, AC adapter, USB cable, Setup DVD-ROM
Optical Resolution	600 dpi	Standard Model*17	PA03836-B005
Output Resolution*4	50 to 600 dpi (adjustable by 1 dpi increments), 1,200 dpi (driver)*5	Trade Compliant Model*17	PA03836-B015
Output Format	Color: 24-bit, Grayscale: 8-bit, Monochrome: 1-bit		
Background Colors	White		
Document Size			
Maximum	216 x 355.6 mm (8.5 x 14 in.)		
Minimum	50.8 x 50.8 mm (2 x 2 in.)		
Long Page Scanning*6	5,588 mm (220 in.)		
(Maximum)			
Paper Weight (Thickness)			
Paper	40 to 209 g/m ² (11 to 56 lb)*7		
Plastic Card	0.76 mm (0.0299 in.) or less*8		
ADF Capacity*9*10	50 sheets (A4 80 g/m ² or Letter 20 lb)		
Expected Daily Volume*11	6,000 sheets		
Multifeed Detection	Overlap detection (Ultrasonic sensor), Length detection		
Interface			
USB	USB 3.2 Gen1x1/USB 3.0/USB 2.0/USB 1.1		
Ethernet	10BASE-T, 100BASE-TX, 1000BASE-T		
Power Requirements	AC 100 to 240 V ±10 %		
Power Consumption			
Operating Mode	19 W or less		
Sleep Mode	1.9 W or less (Normal mode)		
Auto Standby (Off) Mode	0.15 W or less		



Service Programs & Options

1 Year Advantage Exchange Warranty	S8040-AEPWNBD-1	One or three year programs offer whole-unit, next business day replacement for scanner equipment*	Industry-leading support keeps digital transformation projects on-time and on budget <ul style="list-style-type: none"> • U.S. based support • Specialized Teams • Flexible service programs
3 Year Advantage Exchange Warranty	S8040-AEMYNBD-3		
1 Year Depot Warranty	S8040-DEPW5DY-1	One or three year scanner contract provides mail-in unit repair that includes spare parts, labor, and one-way shipping to customer	
3 Year Depot Warranty	S8040-DEPW5DY-3	PaperStream Capture Pro optional license	
PaperStream Capture Pro Scan Station (WG)	PSCP-WG-0001		

*Replacement units shipped overnight for all requests received by 2 P.M. PST

Consumables and Options

Photo Carrier Sheets	PA03770-0015	Pack of 3 Sheets
Carrier Sheets	PA03360-0013	Pack of 5 Sheets
Roller Set	PA03750-0001	Every 100,000 sheets or one year

*1 Scanning speeds may vary due to the system environment. For details, please visit our website at: <https://www.pfu.ricoh.com/global/scanners/fi/>. *2 Indicated speeds are from using JPEG compression. *3 Indicated speeds are from using TIFF CCITT Group 4 compression. *4 Selectable maximum resolution may vary depending on the length of the scanned document. *5 Limitations may apply to the size of documents that can be scanned, depending on system environment, when scanning at high resolution (over 600 dpi). *6 Capable of scanning documents longer than A4 (210 x 297 mm / 8.3 x 11.7 in.) sizes. When using PaperStream IP (TWAIN/ISIS) to scan at 200 dpi, the maximum scanning length is 5,588 mm (220 in.). *7 Thicknesses of up to 128 to 209 g/m² (34 to 56 lb) can be scanned for A8 (52 x 74 mm / 2.1 x 2.9 in.) sizes. *8 Multiple cards cannot be set continuously (Note: capable of scanning embossed cards). *9 Maximum capacity depends on paper weight and may vary. *10 Capable of setting additional documents while scanning. *11 Numbers are calculated using scanning speeds and typical hours of scanner use, and are not meant to guarantee daily volume or unit durability. *12 Excludes the ADF paper chute and stacker. *13 fi Series scanners do not run with Windows® 11 and 10 ARM-based PCs. *14 Functions equivalent to those offered by PaperStream IP may not be available with the Image Scanner Driver for macOS/Linux or WIA Driver. *15 Refer to the fi Series Support Site for driver/software downloads and full lineup of all supported operating system versions. *16 Some functions do not apply when using the "DirectScan" function. Refer to the fi Series Support Site for the latest functions. *17 EPEAT is Silver.

Trademarks

ISIS is a trademark of Open Text. Microsoft, Windows, and Windows Server are either registered trademarks or trademarks of Microsoft Corporation in the United States and/or other countries. macOS is a trademark of Apple Inc., registered in the U.S. and other countries. Linux is the registered trademark of Linus Torvalds in the U.S. and other countries. Any other products or company names appearing in this document are the trademarks or registered trademarks of the respective companies.

Safety Precautions

Please carefully read the safety precautions prior to the use of this device and follow the recommended instructions for correct use. Do not place this device in wet, moist, highly humid, dusty or oily areas. Use of this device under such conditions may result in electrical shock, fire or damage to the device. Please use this device within the power ratings listed.

ENERGY STAR®

PFU Limited has determined that this product meets the ENERGY STAR® guidelines for energy efficiency. ENERGY STAR® is a registered trademark of the United States. Specifications are subject to change without notice.

EPEAT

EPEAT mark is the trademark of Global Electronics Council (GEC). Disposing of e-waste in an environmentally friendly way is the right thing to do. The purchaser can recycle with your State or Local recycling program, or you can recycle with us. We offer the product take back service for product and packaging. For more information, visit our website, <https://www.pfu-us.ricoh.com/about-us/environment>

Specifications are subject to change without notice. Visit the fi Series website for more information. www.RicohDocumentScanners.com



To learn more, visit us at www.RicohDocumentScanners.com or contact us at (888) 425-8228.

Copyright © 2023 PFU America, Inc. All other trademarks are the property of their respective owners.

V1_fi8040_062823