

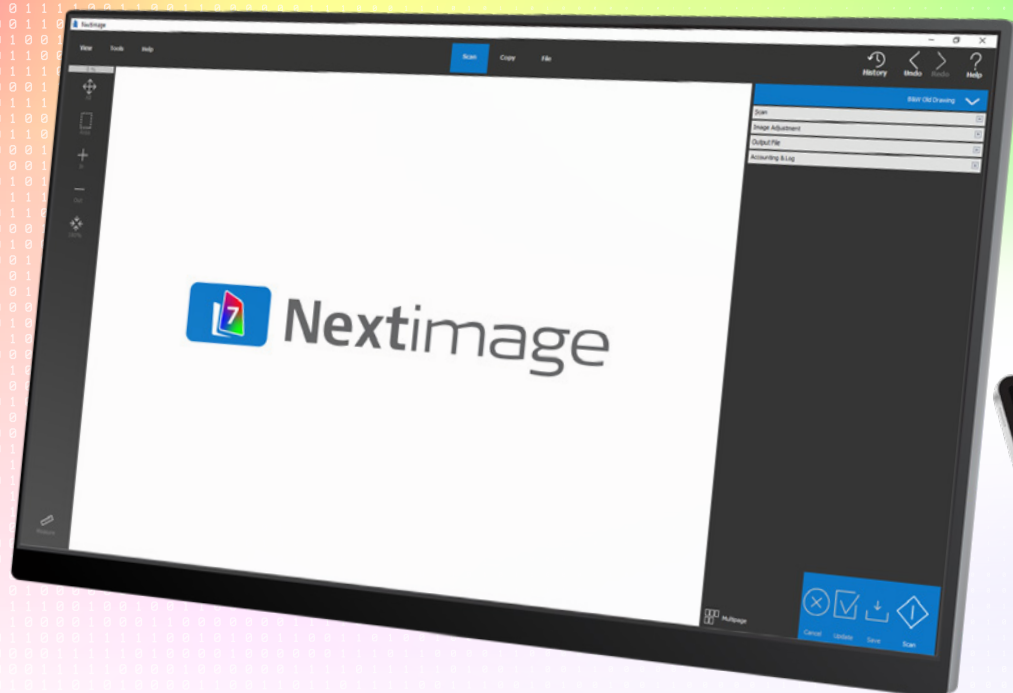

# Nextimage

HD IQ SD

PROFESSIONAL  
SOFTWARE



## AWARD-WINNING SOFTWARE FOR LARGE FORMAT SCANNING



**Nextimage Scan & Archive** optimizes your scan and archive results.  
**Nextimage Repro** includes batch scan and copy functions, closed loop calibration (CLC) and touchscreen compatibility.

### More than just scanning

Nextimage brings out unseen details and restores even the faintest originals. Scan in vibrant color in sRGB, Adobe RGB or Device RGB. Capture and improve maps using advanced filters color reduction options. Digitize and restore monochrome originals with unique adaptive filters and advanced background suppression.

### No file size limit

Utilizing the full 64-bit OS, Nextimage is able to capture the longest originals in the industry. No original is too big for this software! When scanning to TIFF and PDF file formats, there are no limits to the length of your original.

### Save time with Nextimage Remote app for Apple and Android tablets

Nextimage Remote app cleverly mimics the Nextimage program running on the PC. This app can vastly reduce the amount the operator needs to move between the scanner and the workstation.

### ICC color profiles

The ICC color management in Nextimage 7 is powered by X-Rite®.

### Exceeding FADGI 3-stars

The image quality from Nextimage 7 exceeds the FADGI 3-star standard when used with HD Ultra X, IQ Quattro X, IQ FLEX, SD One X, ScanStation Pro, MFP Repro and SD One MF.

### Batch scanning

No need to press 'scan' every single time you feed the scanner a new original.

### Soft-handling

Use this option to have the scanner take extra special care when loading, accelerating and ejecting by slowing everything down a little bit.

### Printer compatibility

No large format scanner software has a longer list of compatible printer drivers than Nextimage.

**THE BEST YOU CAN DO FOR YOUR ORIGINALS**

**SEE MORE:** [context.com/nextimage-7](http://context.com/nextimage-7)

 **context®**  
WHEN IMAGING MATTERS

NEXTIMAGE SOFTWARE SPECIFICATIONS	
Built-in wide format printers support	Canon, HP, Epson, Océ, MUTOH, others. See all printers: <a href="https://context.com/nextimage-supported-printers">context.com/nextimage-supported-printers</a>
Contex recommends	Intel Core i5, AMD Ryzen 5 5500, or better 64-bit processors, 16 GB RAM and SSD SATA drive, min. USB 3.0 or Gigabit Ethernet
Operating systems	Windows 11 64-bit, Windows Server 2025 Standard Edition
File formats	Multipage PDF & TIF, JPG, PDF, PDF/A, DWF, CALS, BMP, JPEG-2000(JP2), JPEG2000 Extended(JPX), TIF-G3, TIF-G4, and others
Supported languages	Chinese, Dutch, English, French, German, Italian, Japanese, Korean, Polish, Russian, Spanish
Nextimage Repro free trial	With a Contex scanner: 15 hours of scanning. With no scanner: Unlimited scanning.

	SCAN & ARCHIVE	REPRO
	For powerful and user-friendly scanning and archiving	Includes direct copy functionality and touchscreen compatibility
Windows application	Standard	Standard or touchscreen mode
	FULL SCAN FUNCTIONS	
ICC color management powered by X-Rite®	✓	✓
Multiple exposures (exceed FADGI 3-stars) <sup>1</sup>	✓	✓
Batch scanning	✓	✓
SnapScan: Scan – Enhance – Save	✓	✓
REimage <sup>2</sup>	✓	✓
Automatic file naming templates	✓	✓
Customize/Edit index color palette	✓	✓
Accounting	✓	✓
	FULL IMAGE ADJUSTMENT CONTROL	
Auto-rotate	✓	✓
Auto-align/deskew	✓	✓
Sharpen/Smoothen filter	✓	✓
Black/White level adjustment	✓	✓
RGB level adjustments	✓	✓
Histogram view	✓	✓
Measurement tool	✓	✓
TWAIN driver	✓	✓
	FULL COPY FUNCTIONS	
Direct copy		✓
Batch copy		✓
Closed loop color calibration		✓

1. Scan with multiple exposures per scan line with the 'Quality' option to significantly reduce image noise and ensure more accurate colors. Applicable for: HD Ultra X, IQ Quattro X, IQ FLEX, SD One X, ScanStation Pro, MFP Repro, SD One MF.
2. Reopen scanned images with the RAW image information still intact and adjustable

## Nextimage software supports all Contex scanners and delivers a complete set of tools to ensure image quality for all tasks.

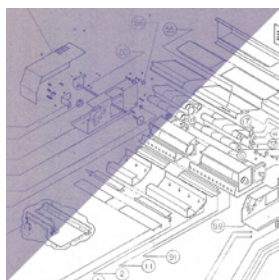

**Adaptive threshold algorithm**  
Nextimage comes with an advanced B&W algorithm that combines background cleaning and preservation of grayscales in one mode. Use it for both clean new originals and for low contrast blueprints.



**Smoothen/sharpen filters**  
The smart Smoothen filter intelligently removes pattern noise without blurring the edges in the original. Combine it with the Sharpen algorithm to get razor sharp results with smooth noiseless colors.

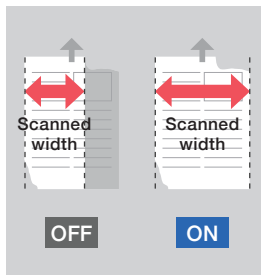

**Full length auto size**  
Nextimage full length auto size ensures all available information is scanned even if more than one edge is incomplete.

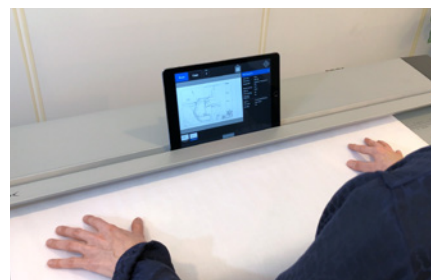

**Workflow optimized**  
Remote control and operate Nextimage software from your tablet with Nextimage Remote (see App Store and Google Play for tablet specifications). The Nextimage Remote app allows the Nextimage software to be operated right on top of the scanner for maximum convenience and user comfort.

Contex solutions are compatible with all leading large-format printers. See the full list at [context.com/nextimage-supported-printers](https://context.com/nextimage-supported-printers)



[context.com/nextimage-7](https://context.com/nextimage-7)

**Contex HQ & EMEA**  
Global Scanning Denmark A/S  
Copenhagen, Denmark  
Phone: +45 4814 1122  
[info@context.com](mailto:info@context.com)

**Contex Americas**  
Global Scanning Americas Inc.  
Chantilly, VA, 20151, USA  
Phone: +1 (877) 226 6839  
[salesamericas@context.com](mailto:salesamericas@context.com)

**Contex Japan & Asia**  
Global Scanning Japan A/S  
Yokohama, Japan  
Phone: +81 45 548 8547  
[apac@context.com](mailto:apac@context.com)

